

### Engine Stand, Main Frame

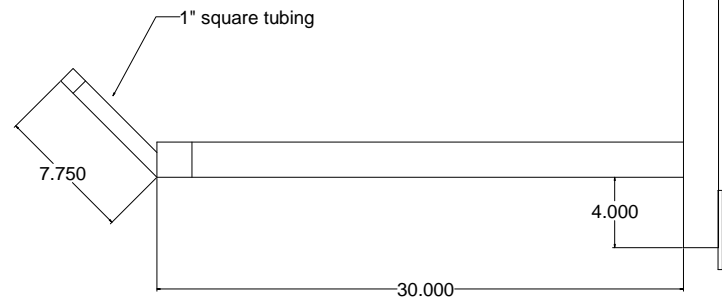

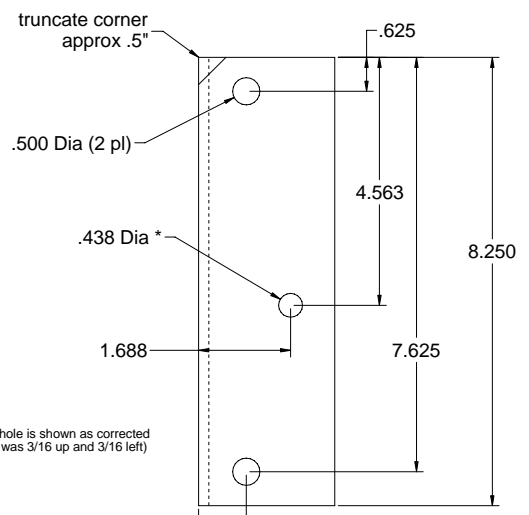
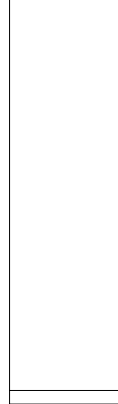
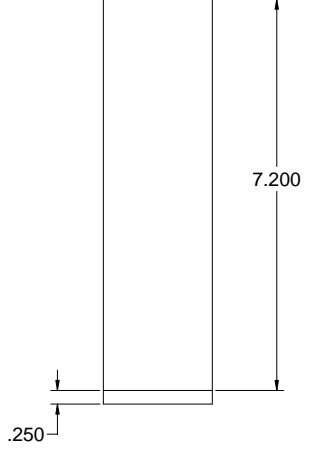
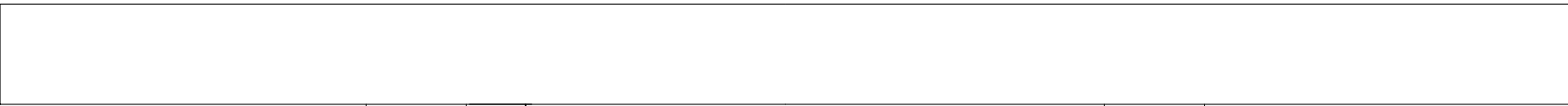

\*Center hole is shown as corrected (original was 3/16 up and 3/16 left)

Install CarQuest MOU 31-3097 motor mounts with studs towards center (78-79 Buick/Olds, 79 Chev, 75-76 Pontiac Transmission Mount)

See Mountbar.dc for main bar dims

Mount is to place crankshaft 10" above main frame

Mtl: 1.5 x 2.5 x .187 steel

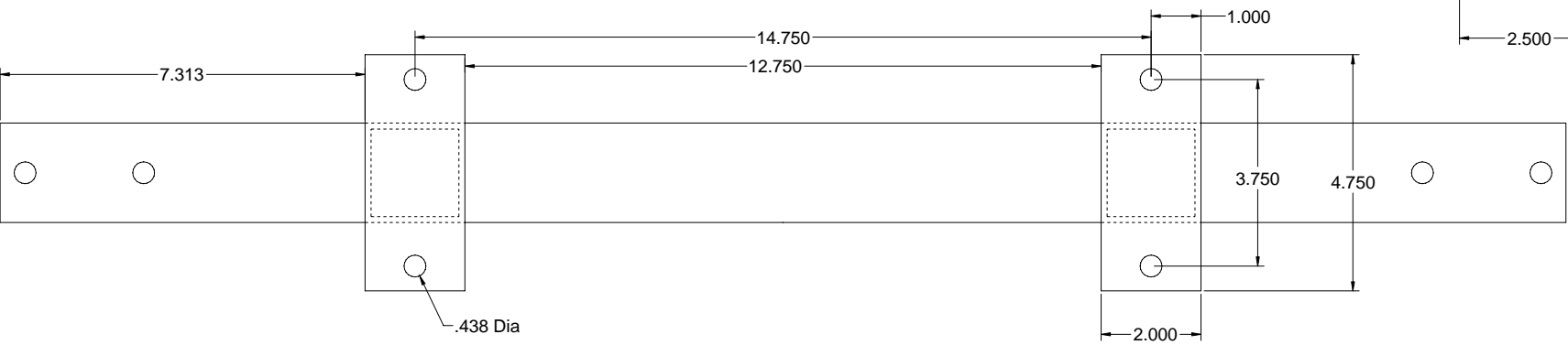
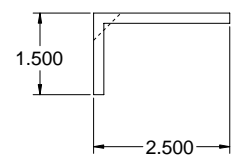

Small Block Ford Front Engine Mount Bar (mountbarSBFfront.dc)

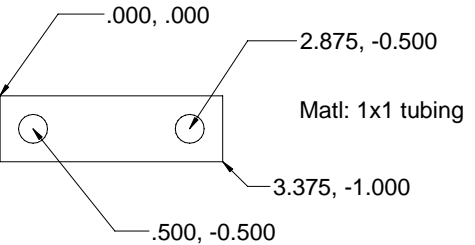

Generic Engine Mount Bar (mountbar.dc)

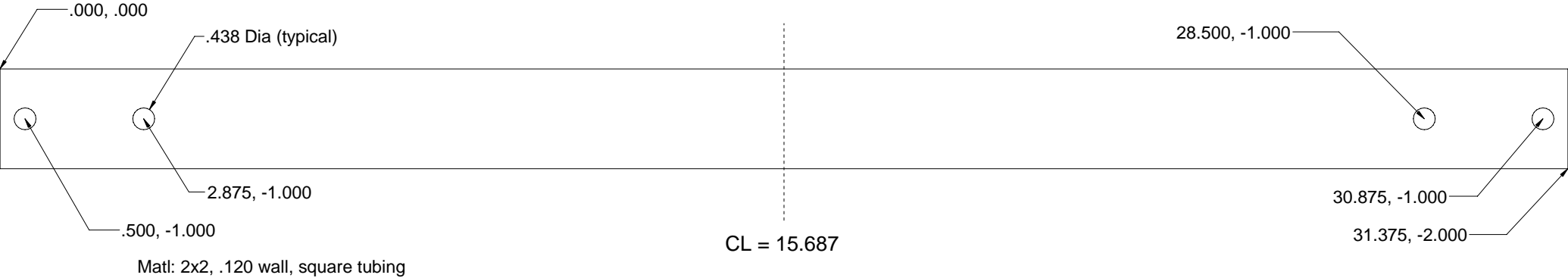

MountBarFordRear.dc

Supports GM T-10, T5 and Tremec

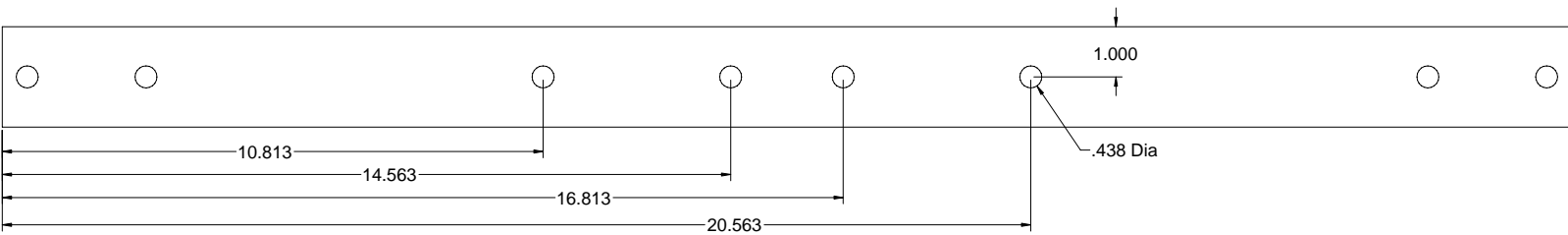
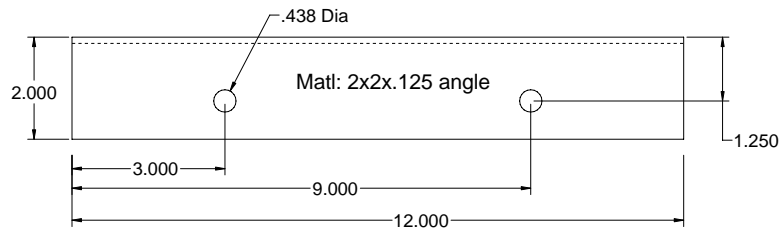
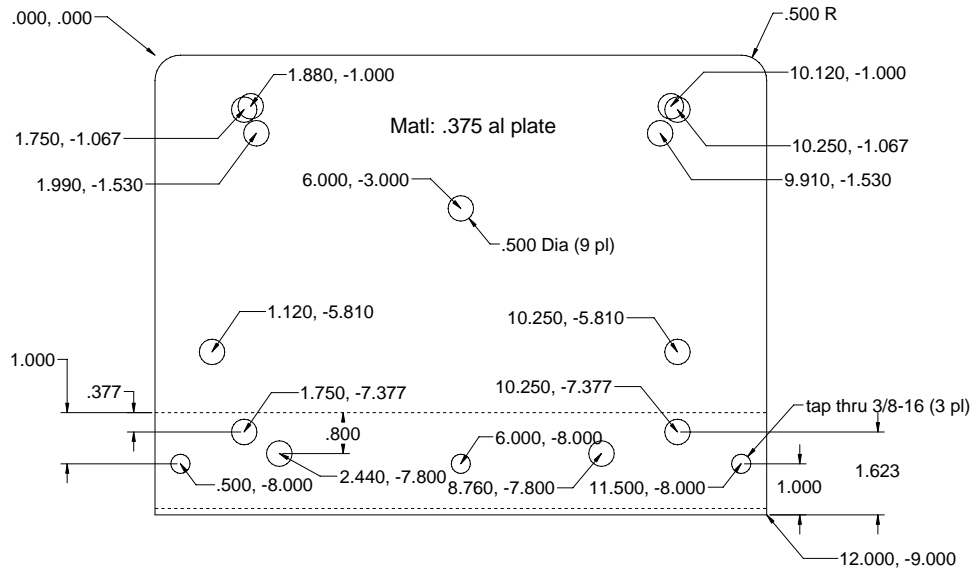

Install CarQuest MOU 31-3097 motor mounts  
(78-79 Buick/Olds, 79 Chev, 75-76 Pontiac Transmission Mount)

See Mountbar.dc for main bar dims

Mount is to place crankshaft 10" above main frame

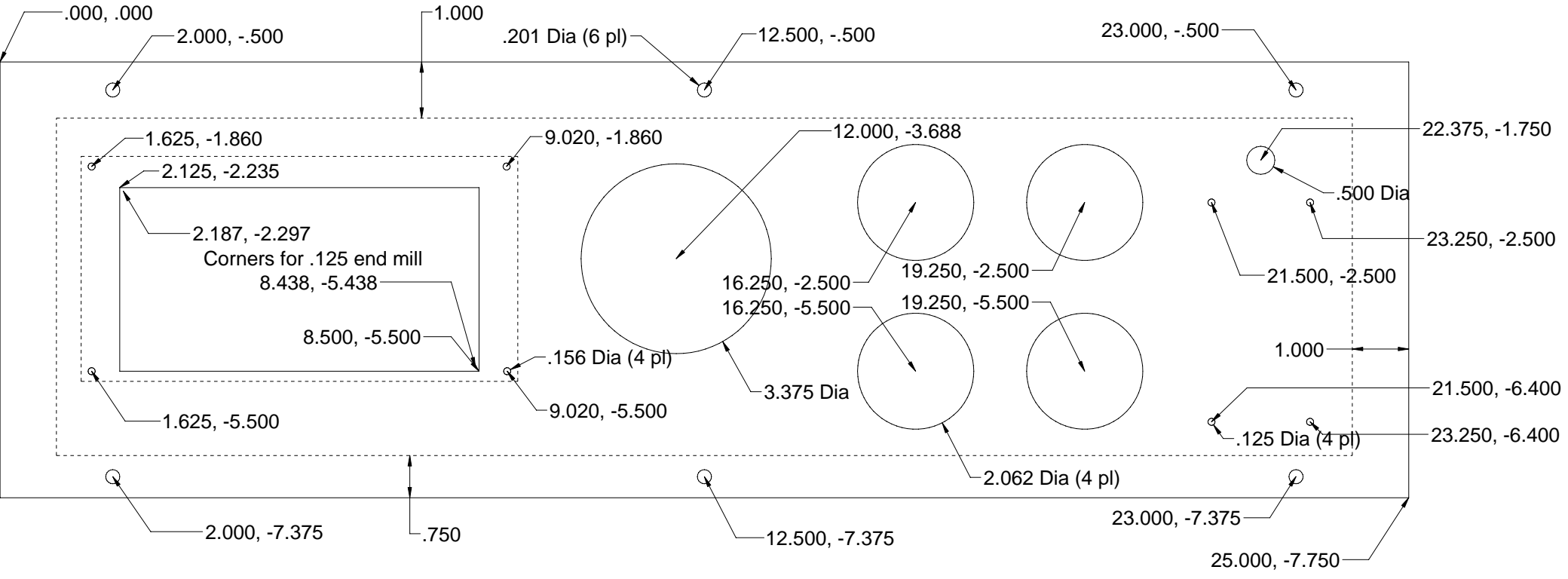

MountBarDashPanel



Install CarQuest MOU 31-3097 motor mounts with studs towards center  
 (78-79 Buick/Olds, 79 Chev, 75-76 Pontiac Transmission Mount)  
 See Mountbar.dc for main bar dims

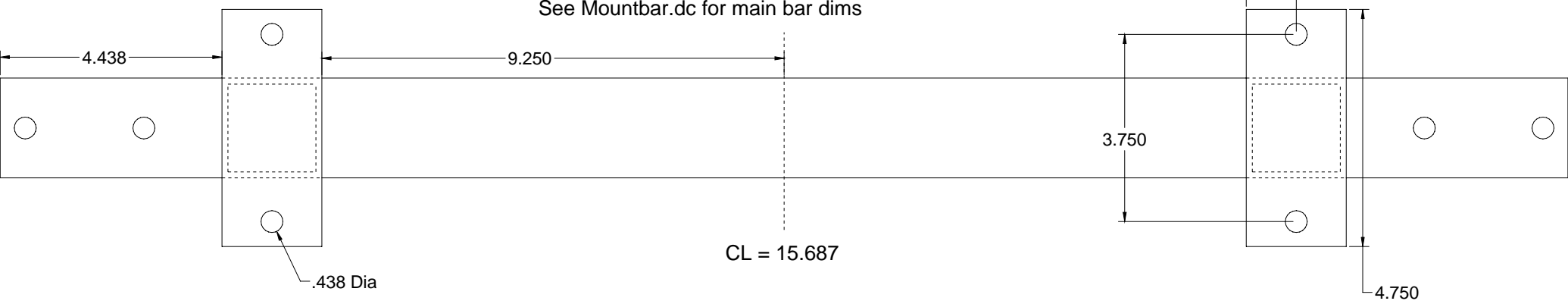

Flathead Front Engine Mount Bar (mountbarflatheadfront.dc)